

# ODF-DIN DOUBLE Industrial Splice Box Q-Fiber

## Description

The **ODF-DIN DOUBLE Industrial Splice Box Q-Fiber** is used for crossing-over cables in large-scale automation systems. Its small size and a grip on the rail (TS35) make the splice box suitable for mounting in every cabinet. ODF-DIN can be fitted with a bracket for mounting on the wall. The embossing for attaching fiber optic cables inside the splice box enable easy, functional and aesthetic organization of cables and fiber optic pigtails. ODF-DIN holds up to 24 fiber optic fusion splice protector sleeves.



## Application

Telecommunication , CATV, Monitoring, Industry, LAN, MAN

## Properties

- Made of 1,2mm steel sheet,
- Embossing to attach cables inside the box,
- The possibility of mounting a bracket to mounting the splice box on a DIN rail,
- The possibility of mounting a bracket to mounting the splice box on a wall,
- Two holes for cable glands M16x1.5,
- Two holes for cable glands M20x1.5,
- Cable gland protection against fracture possible,
- Colour: RAL 7035 (light grey) glossy, other colour on request,
- Dimensions [H x W x D]: 120x120x71 [mm]

## Photos

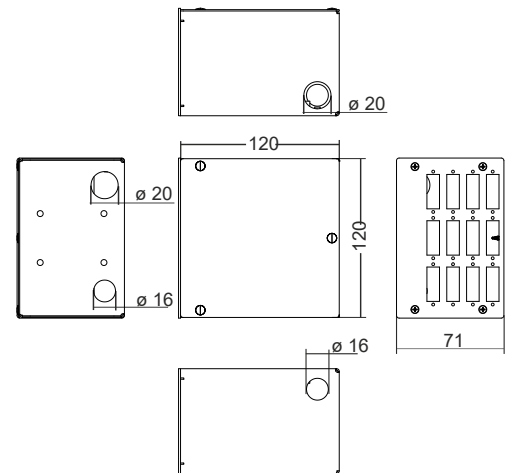

## How to order

ODFWBDIN	ODF-DIN DOUBLE Industrial Splice Box
FPN24CSGD	Front Panel ODF-DIN 24xSC/E2000 simplex*
FPN24STGD	Front Panel ODF-DIN 24xST/FC/DIN d-hole
FPN12CDGD	Front Panel ODF-DIN 12xSC duplex
UDDIND2	DIN clip for ODF-DIN DOUBLE 2 pcs.
USDIND	Wall clip for ODF-DIN DOUBLE

\* Suitable for LC/LX.5/MTRJ duplex SC foot print

\*\* Possibility to order a splice box with holders for 12 easy crimp ANT clamps

## Information

- The ODF holds up to 24 fibre optic fusion splice protector,
- The possibility to route 24 connection onto the front panel.

## Standard equipment

- Cable gland M20x1,5 ( $\varnothing$  kabela 6÷13 mm) (1 pc),
- Mounting bolt  $\varnothing$  4x20 mm (3 pcs),
- Nylon cable tie 80x2,5 mm (6 pcs),
- Round cap (3 pcs),
- Holder for 24 splice protector sleeve (1 pcs),
- Holder for installation on the DIN rail or wall mounting (to be chosen) (1 est).

## Additional equipment

- Pigtails,
- Adapters,
- Fiber optic fusion splice protector sleeves.